

FOR SALE / FOR LEASE

7110 NE 4 CT

LITTLE RIVER





Keith A. Darby, CCIM
President

ADDRESS:

200 S. Biscayne Blvd, Suite 300

WEBSITE:

RiseRealty.com

CONTACT:

305.859.1606

EMAIL:

keith@riserealty.com

THE INFORMATION CONTAINED HEREIN WAS OBTAINED FROM SOURCES BELIEVED RELIABLE; HOWEVER RISE REALTY MAKES NO GUARANTEES, WARRANTIES OR REPRESENTATIONS AS TO THE COMPLETENESS OR ACCURACY THEREOF. THE PRESENTATION OF THIS PROPERTY IS SUBJECT TO ERRORS, OMISSIONS, CHANGE OF PRICE, OR CONDITIONS, PRIOR TO SALE OR LEASE, OR WITHDRAWL WITHOUT NOTICE.

PROPERTY HIGHLIGHTS

FOLIO: 01-3207-040-2100
01-3207-040-2110
01-3207-040-2120
01-3207-040-2130
01-3207-040-2790

PRICE: \$18 PER SF NNN

LAND AREA: 52,250 SF

ADDITIONAL: 4 LOADING DOCKS, A/C POTENTIAL,
YARD, PARKING

ZONING: LIVE WORK

BUILDING 1: 20,700 SF AVAILABLE
BUILDING 2: 13,000 SF LEASED

USES: INDUSTRIAL-GENERAL

LOCATION: LITTLE RIVER

OPPORTUNITY FOR SALE OR LEASE



Keith A. Darby, CCIM
President

ADDRESS:

200 S. Biscayne Blvd, Suite 300

WEBSITE:

RiseRealty.com

CONTACT:

305.859.1606

EMAIL:

keith@riserealty.com

THE INFORMATION CONTAINED HEREIN WAS OBTAINED FROM SOURCES BELIEVED RELIABLE; HOWEVER RISE REALTY MAKES NO GUARANTEES, WARRANTIES OR REPRESENTATIONS AS TO THE COMPLETENESS OR ACCURACY THEREOF. THE PRESENTATION OF THIS PROPERTY IS SUBJECT TO ERRORS, OMISSIONS, CHANGE OF PRICE, OR CONDITIONS, PRIOR TO SALE OR LEASE, OR WITHDRAWAL WITHOUT NOTICE.

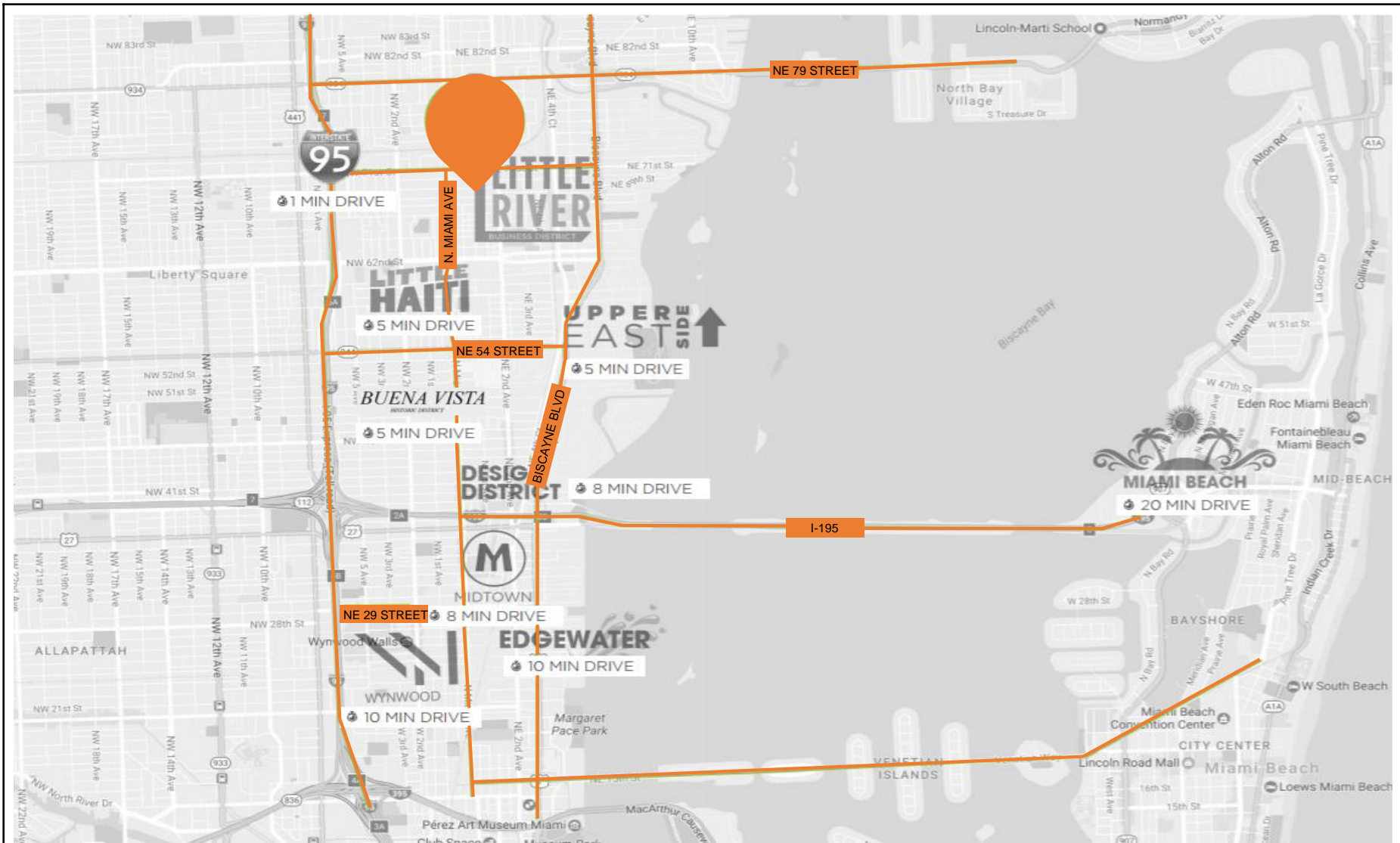

Keith A. Darby, CCIM
 President

ADDRESS:	WEBSITE:	CONTACT:	EMAIL:
200 S. Biscayne Blvd, Suite 300	RiseRealty.com	305.859.1606	keith@riserealty.com

THE INFORMATION CONTAINED HEREIN WAS OBTAINED FROM SOURCES BELIEVED RELIABLE; HOWEVER RISE REALTY MAKES NO GUARANTEES, WARRANTIES OR REPRESENTATIONS AS TO THE COMPLETENESS OR ACCURACY THEREOF. THE PRESENTATION OF THIS PROPERTY IS SUBJECT TO ERRORS, OMISSIONS, CHANGE OF PRICE, OR CONDITIONS, PRIOR TO SALE OR LEASE, OR WITHDRAWAL WITHOUT NOTICE.

FLOOR PLAN

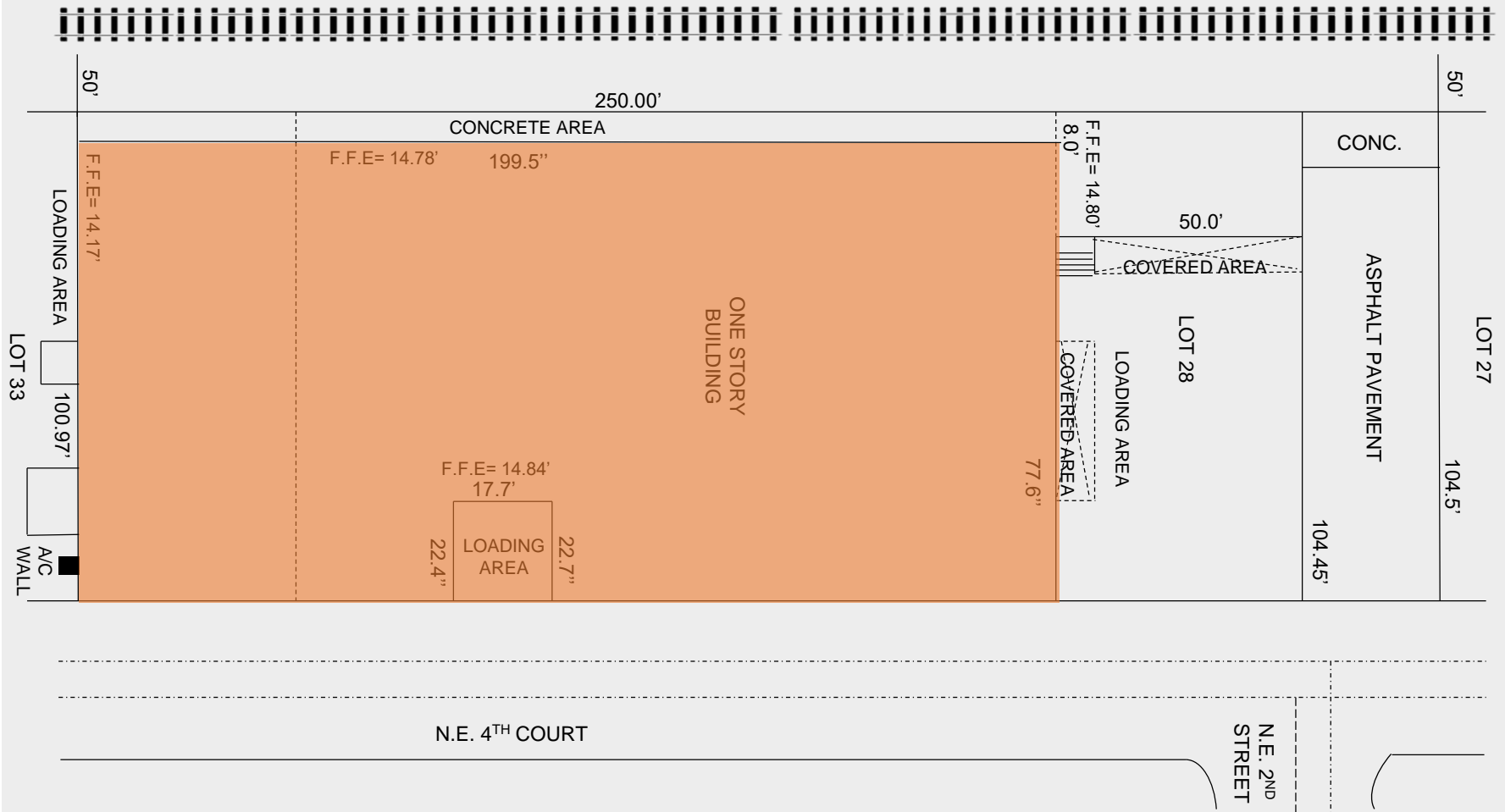

Keith A. Darby, CCIM
President

ADDRESS:	WEBSITE:	CONTACT:	EMAIL:
200 S. Biscayne Blvd, Suite 300	RiseRealty.com	305.859.1606	keith@riserealty.com

THE INFORMATION CONTAINED HEREIN WAS OBTAINED FROM SOURCES BELIEVED RELIABLE; HOWEVER RISE REALTY MAKES NO GUARANTEES, WARRANTIES OR REPRESENTATIONS AS TO THE COMPLETENESS OR ACCURACY THEREOF. THE PRESENTATION OF THIS PROPERTY IS SUBJECT TO ERRORS, OMISSIONS, CHANGE OF PRICE, OR CONDITIONS, PRIOR TO SALE OR LEASE, OR WITHDRAWAL WITHOUT NOTICE.

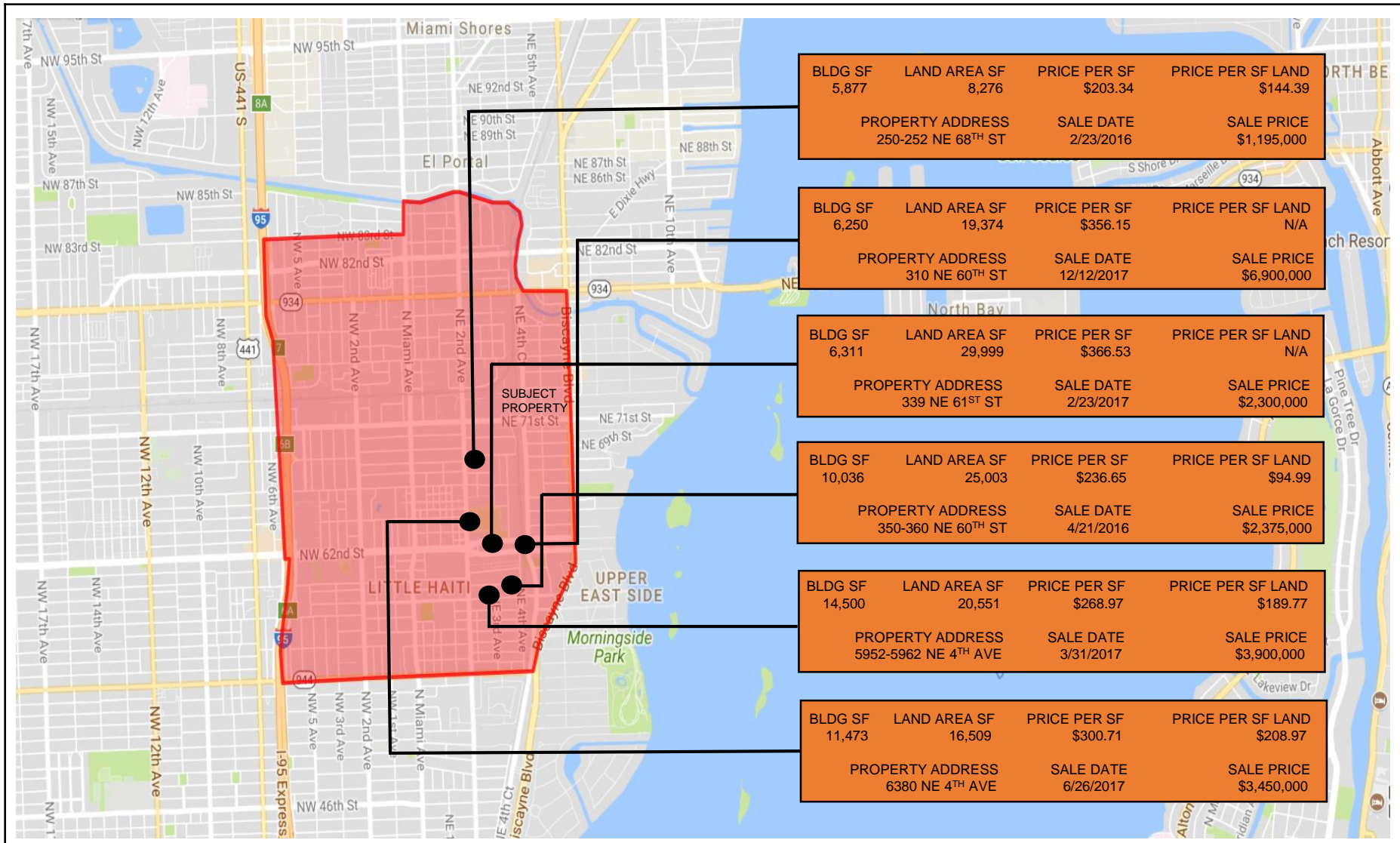

BLDG SF	LAND AREA SF	PRICE PER SF	PRICE PER SF LAND
5,877	8,276	\$203.34	\$144.39
PROPERTY ADDRESS		SALE DATE	SALE PRICE
250-252 NE 68 TH ST		2/23/2016	\$1,195,000

BLDG SF	LAND AREA SF	PRICE PER SF	PRICE PER SF LAND
6,250	19,374	\$356.15	N/A
PROPERTY ADDRESS		SALE DATE	SALE PRICE
310 NE 60 TH ST		12/12/2017	\$6,900,000

BLDG SF	LAND AREA SF	PRICE PER SF	PRICE PER SF LAND
6,311	29,999	\$366.53	N/A
PROPERTY ADDRESS		SALE DATE	SALE PRICE
339 NE 61 ST ST		2/23/2017	\$2,300,000

BLDG SF	LAND AREA SF	PRICE PER SF	PRICE PER SF LAND
10,036	25,003	\$236.65	\$94.99
PROPERTY ADDRESS		SALE DATE	SALE PRICE
350-360 NE 60 TH ST		4/21/2016	\$2,375,000

BLDG SF	LAND AREA SF	PRICE PER SF	PRICE PER SF LAND
14,500	20,551	\$268.97	\$189.77
PROPERTY ADDRESS		SALE DATE	SALE PRICE
5952-5962 NE 4 TH AVE		3/31/2017	\$3,900,000

BLDG SF	LAND AREA SF	PRICE PER SF	PRICE PER SF LAND
11,473	16,509	\$300.71	\$208.97
PROPERTY ADDRESS		SALE DATE	SALE PRICE
6380 NE 4 TH AVE		6/26/2017	\$3,450,000



Keith A. Darby, CCIM
President

ADDRESS:	WEBSITE:	CONTACT:	EMAIL:
200 S. Biscayne Blvd, Suite 300	RiseRealty.com	305.859.1606	keith@riserealty.com

THE INFORMATION CONTAINED HEREIN WAS OBTAINED FROM SOURCES BELIEVED RELIABLE; HOWEVER RISE REALTY MAKES NO GUARANTEES, WARRANTIES OR REPRESENTATIONS AS TO THE COMPLETENESS OR ACCURACY THEREOF. THE PRESENTATION OF THIS PROPERTY IS SUBJECT TO ERRORS, OMISSIONS, CHANGE OF PRICE, OR CONDITIONS, PRIOR TO SALE OR LEASE, OR WITHDRAWAL WITHOUT NOTICE.

LITTLE RIVER PALM GROVE ASSEMBLAGE



Keith A. Darby, CCIM
President

ADDRESS:

200 S. Biscayne Blvd, Suite 300

WEBSITE:

RiseRealty.com

CONTACT:

305.859.1606

EMAIL:

keith@riserealty.com

THE INFORMATION CONTAINED HEREIN WAS OBTAINED FROM SOURCES BELIEVED RELIABLE; HOWEVER RISE REALTY MAKES NO GUARANTEES, WARRANTIES OR REPRESENTATIONS AS TO THE COMPLETENESS OR ACCURACY THEREOF. THE PRESENTATION OF THIS PROPERTY IS SUBJECT TO ERRORS, OMISSIONS, CHANGE OF PRICE, OR CONDITIONS, PRIOR TO SALE OR LEASE, OR WITHDRAWAL WITHOUT NOTICE.