

AVAILABLE

7110 NE 4 CT

LITTLE RIVER



RISE
REALTY



Keith A. Darby, CCIM
President

ADDRESS:

200 S. Biscayne Blvd, Suite 300

WEBSITE:

RiseRealty.com

CONTACT:

305.859.1606

EMAIL:

keith@riserealty.com

THE INFORMATION CONTAINED HEREIN WAS OBTAINED FROM SOURCES BELIEVED RELIABLE; HOWEVER RISE REALTY MAKES NO GUARANTEES, WARRANTIES OR REPRESENTATIONS AS TO THE COMPLETENESS OR ACCURACY THEREOF. THE PRESENTATION OF THIS PROPERTY IS SUBJECT TO ERRORS, OMISSIONS, CHANGE OF PRICE, OR CONDITIONS, PRIOR TO SALE OR LEASE, OR WITHDRAWL WITHOUT NOTICE.

PROPERTY HIGHLIGHTS

FOLIO: 01-3207-040-2100
01-3207-040-2110
01-3207-040-2120
01-3207-040-2130
01-3207-040-2790

PRICE: \$18 PER SF NNN

LAND AREA: 52,250 SF

ADDITIONAL: 4 LOADING DOCKS, A/C POTENTIAL,
YARD, PARKING

ZONING: LIVE WORK

BUILDING 1: 20,700 SF AVAILABLE
BUILDING 2: 13,000 SF LEASED

USES: INDUSTRIAL-GENERAL

LOCATION: LITTLE RIVER

OPPORTUNITY FOR SALE OR LEASE



Keith A. Darby, CCIM
President

ADDRESS:

200 S. Biscayne Blvd, Suite 300

WEBSITE:

RiseRealty.com

CONTACT:

305.859.1606

EMAIL:

keith@riserealty.com

THE INFORMATION CONTAINED HEREIN WAS OBTAINED FROM SOURCES BELIEVED RELIABLE; HOWEVER RISE REALTY MAKES NO GUARANTEES, WARRANTIES OR REPRESENTATIONS AS TO THE COMPLETENESS OR ACCURACY THEREOF. THE PRESENTATION OF THIS PROPERTY IS SUBJECT TO ERRORS, OMISSIONS, CHANGE OF PRICE, OR CONDITIONS, PRIOR TO SALE OR LEASE, OR WITHDRAWAL WITHOUT NOTICE.

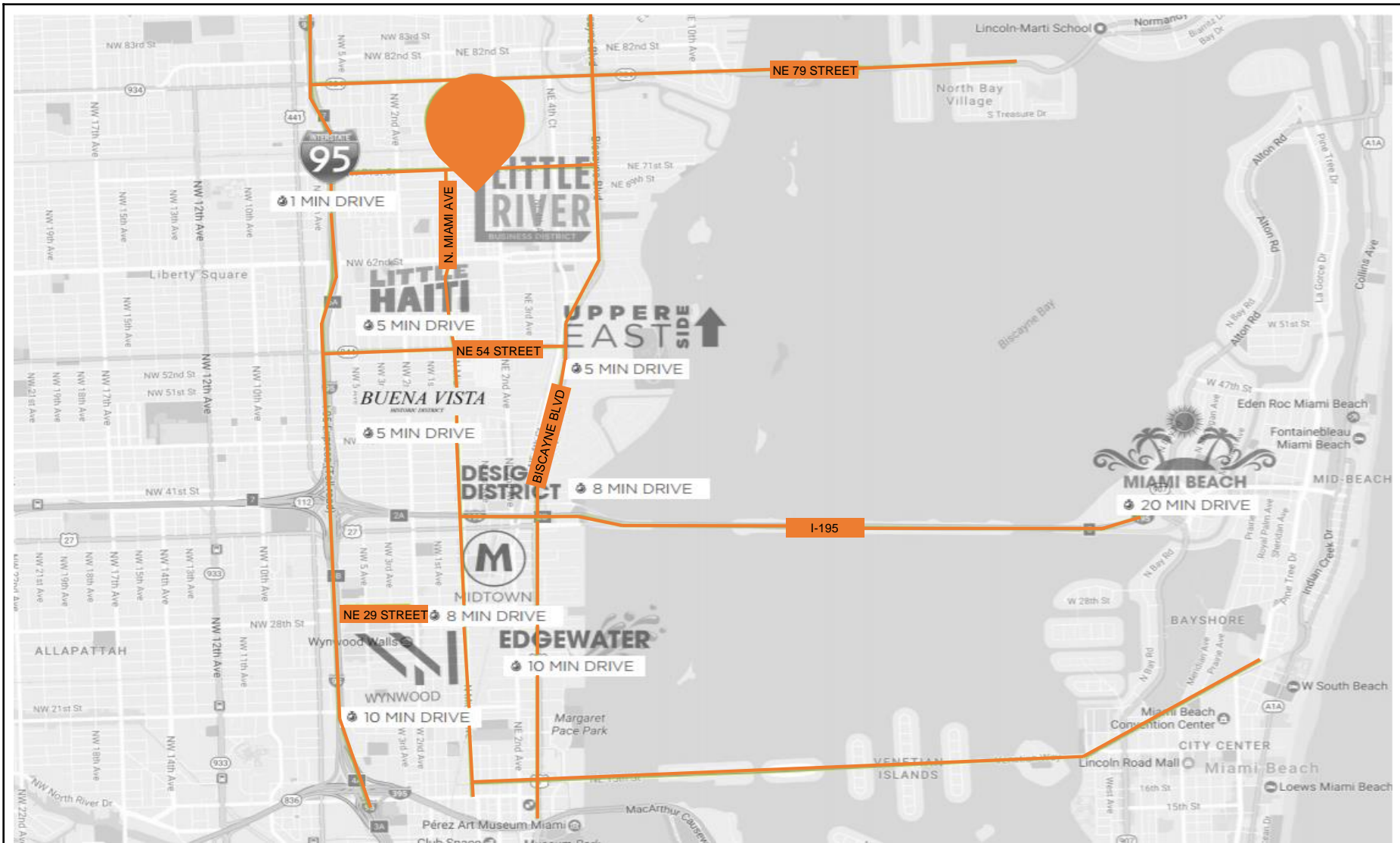

Keith A. Darby, CCIM
President

ADDRESS:	WEBSITE:	CONTACT:	EMAIL:
200 S. Biscayne Blvd, Suite 300	RiseRealty.com	305.859.1606	keith@riserealty.com

THE INFORMATION CONTAINED HEREIN WAS OBTAINED FROM SOURCES BELIEVED RELIABLE; HOWEVER RISE REALTY MAKES NO GUARANTEES, WARRANTIES OR REPRESENTATIONS AS TO THE COMPLETENESS OR ACCURACY THEREOF. THE PRESENTATION OF THIS PROPERTY IS SUBJECT TO ERRORS, OMISSIONS, CHANGE OF PRICE, OR CONDITIONS, PRIOR TO SALE OR LEASE, OR WITHDRAWAL WITHOUT NOTICE.

FLOOR PLAN

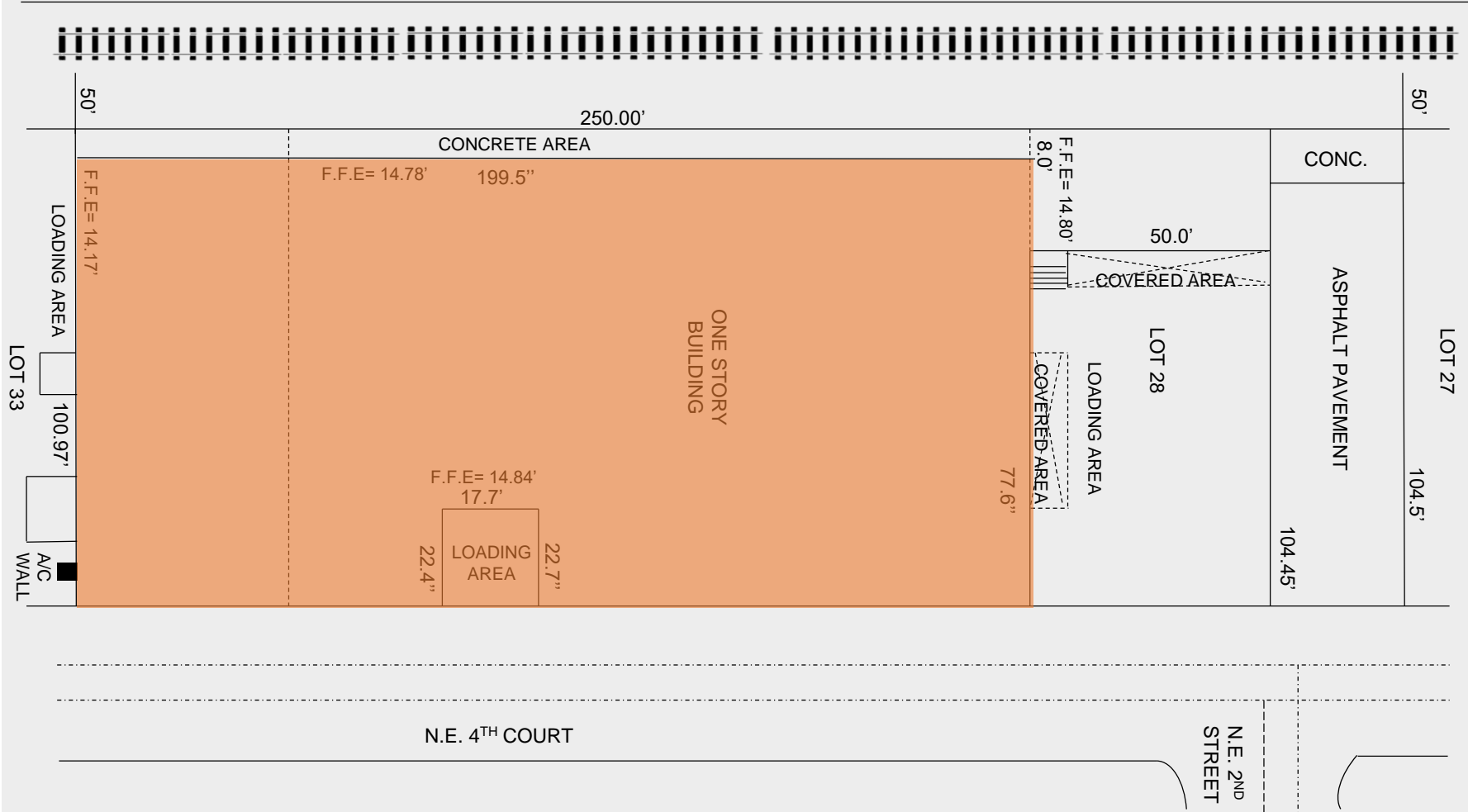

Keith A. Darby, CCIM
 President

ADDRESS:	WEBSITE:	CONTACT:	EMAIL:
200 S. Biscayne Blvd, Suite 300	RiseRealty.com	305.859.1606	keith@riserealty.com

THE INFORMATION CONTAINED HEREIN WAS OBTAINED FROM SOURCES BELIEVED RELIABLE; HOWEVER RISE REALTY MAKES NO GUARANTEES, WARRANTIES OR REPRESENTATIONS AS TO THE COMPLETENESS OR ACCURACY THEREOF. THE PRESENTATION OF THIS PROPERTY IS SUBJECT TO ERRORS, OMISSIONS, CHANGE OF PRICE, OR CONDITIONS, PRIOR TO SALE OR LEASE, OR WITHDRAWAL WITHOUT NOTICE.

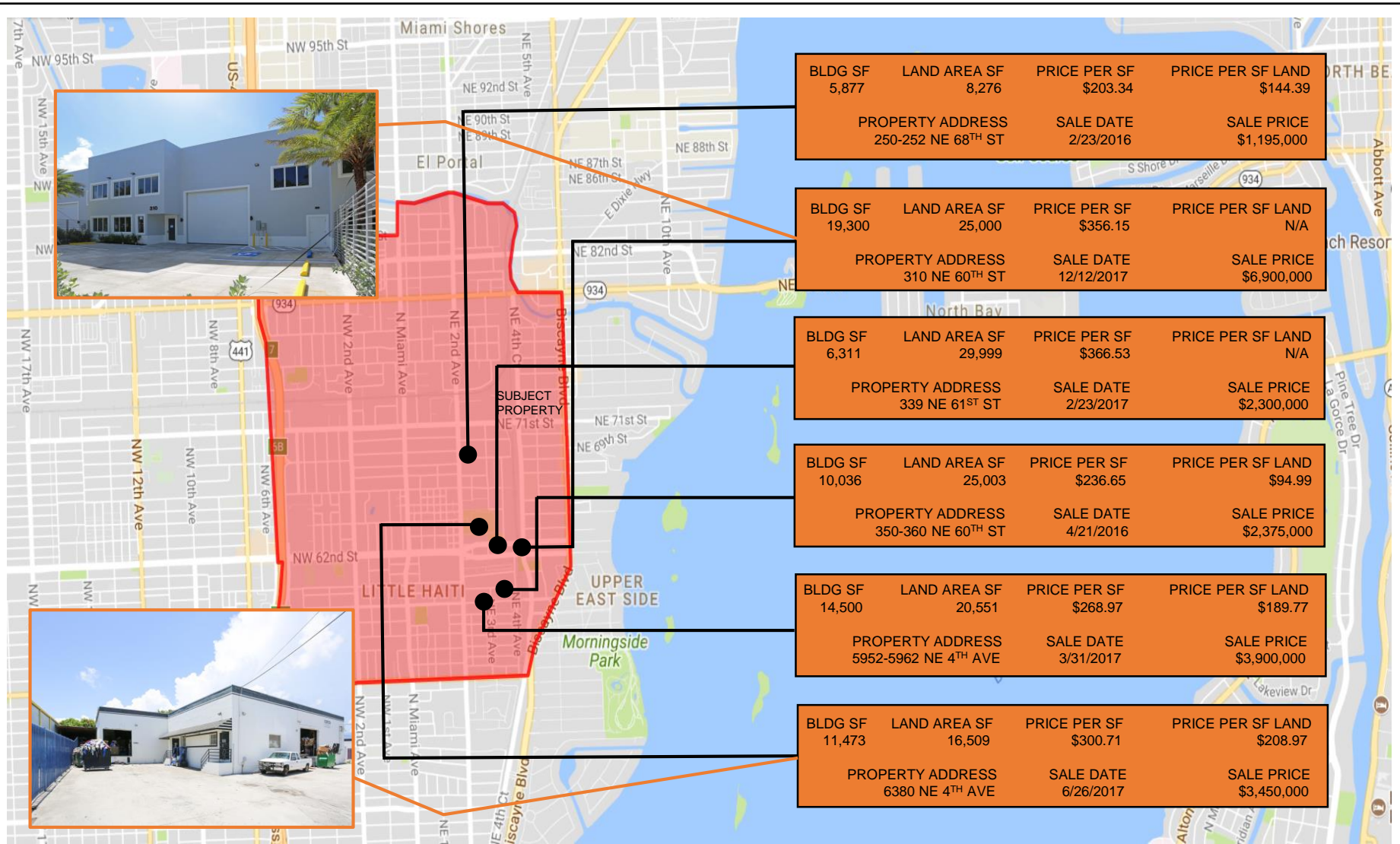

Keith A. Darby, CCIM
President

ADDRESS:	WEBSITE:	CONTACT:	EMAIL:
200 S. Biscayne Blvd, Suite 300	RiseRealty.com	305.859.1606	keith@riserealty.com

THE INFORMATION CONTAINED HEREIN WAS OBTAINED FROM SOURCES BELIEVED RELIABLE; HOWEVER RISE REALTY MAKES NO GUARANTEES, WARRANTIES OR REPRESENTATIONS AS TO THE COMPLETENESS OR ACCURACY THEREOF. THE PRESENTATION OF THIS PROPERTY IS SUBJECT TO ERRORS, OMISSIONS, CHANGE OF PRICE, OR CONDITIONS, PRIOR TO SALE OR LEASE, OR WITHDRAWAL WITHOUT NOTICE.

LITTLE RIVER PALM GROVE ASSEMBLAGE



Keith A. Darby, CCIM
President

ADDRESS:	WEBSITE:	CONTACT:	EMAIL:
200 S. Biscayne Blvd, Suite 300	RiseRealty.com	305.859.1606	keith@riserealty.com

THE INFORMATION CONTAINED HEREIN WAS OBTAINED FROM SOURCES BELIEVED RELIABLE; HOWEVER RISE REALTY MAKES NO GUARANTEES, WARRANTIES OR REPRESENTATIONS AS TO THE COMPLETENESS OR ACCURACY THEREOF. THE PRESENTATION OF THIS PROPERTY IS SUBJECT TO ERRORS, OMISSIONS, CHANGE OF PRICE, OR CONDITIONS, PRIOR TO SALE OR LEASE, OR WITHDRAWAL WITHOUT NOTICE.